

Data Sheet

FH Cabinets

Application

The FH cabinets are basically used for covering manifold installations in floor heated buildings and rooms.

The cabinets can be used with Danfoss FHF and FBH manifold systems and FH-MJA shunts.

The cabinet can be used for:

- **Complete installation (as in picture)**
- **Manifold with shunt**
- **Manifold alone**

Shunts are supplied with dampers and screws, which should be used for mounting. FHF brackets should be used for mounting of manifolds.

Only the cabinet size has to be chosen from the application wanted.



Ordering

Type	Description	Width	Code no.
FH-FCA Cabinet	Flush mounted, white painted	450 mm	088X0400
FH-FCB Cabinet	Flush mounted, white painted	680 mm	088X0401
FH-FCC Cabinet	Flush mounted, white painted	830 mm	088X0402
FH-FCD Cabinet	Flush mounted, white painted	1130 mm	088X0403
FH-SCA Cabinet	Surface mounted, white painted	450 mm	088X0410
FH-SCB Cabinet	Surface mounted, white painted	680 mm	088X0411
FH-SCC Cabinet	Surface mounted, white painted	830 mm	088X0412
FH-SCD Cabinet	Surface mounted, white painted	1030 mm	088X0413
FH-SCE Cabinet	For industrial use, surface mounted, zink plated	1300 mm	088X0420
FH-SCF Cabinet	For industrial use, surface mounted, zink plated	1500 mm	088X0421
FH-SCG Cabinet	For industrial use, surface mounted, zink plated	1700 mm	088X0422

Design

The FH Cabinets are available as

- surface mounted cabinets, which are mounted with fasteners directly upon a wall
- flush mounted, which must be mounted into a wall opening

The cabinets FH-FCA/B/C/D and FH-SCA/B/C/D are powder painted and made from Zink-plated steel plate. The cabinet front door is made from a white polymer plate, which gives a mat finish and easy to clean surface.

The cabinet FH-SCE/F/G has a zink plated surface and zink plated steel plate door.

Dimensions

Surface mounted cabinets

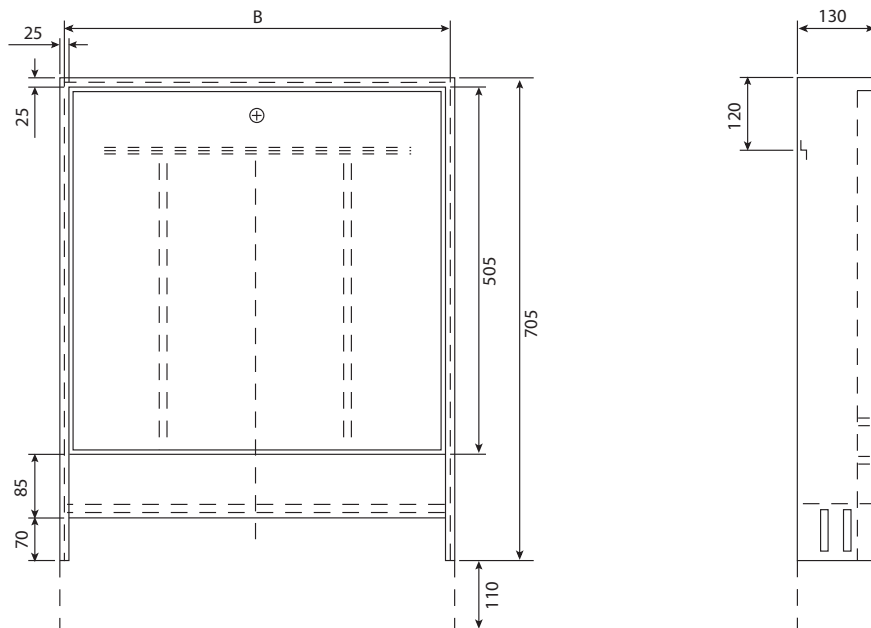

Flush mounted cabinets

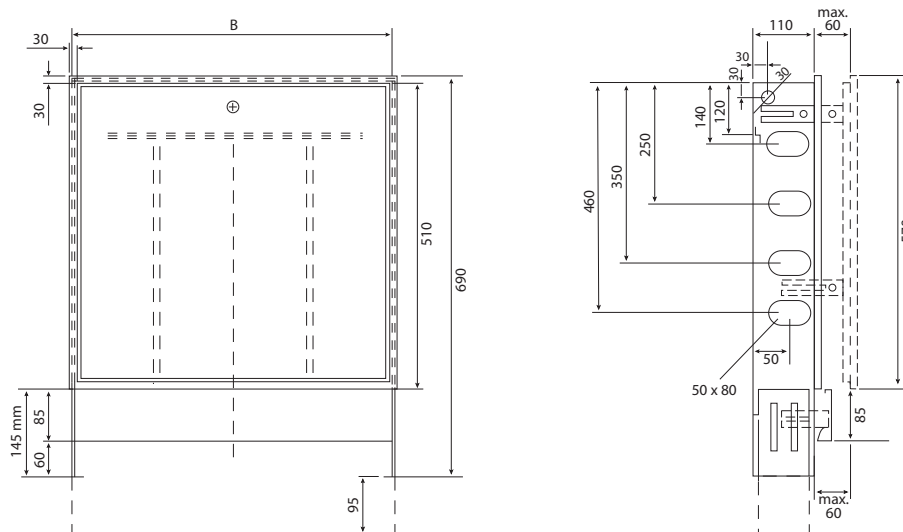

Flush mounted cabinets need a build-in hole, which is about 5 mm larger than the B measure and 600 mm above floor surface.

Flush mounted cabinets are adjustable in depth from 110 mm to 170 mm.

Danfoss A/S
 Heating Solutions
 Haarupvaenget 11
 8600 Silkeborg
 Denmark
 Phone: +45 7488 8000
 Fax: +45 7488 8100
 Email: heating.solutions@danfoss.com
www.heating.danfoss.com

Danfoss can accept no responsibility for possible errors in catalogues, brochures and other printed material. Danfoss reserves the right to alter its products without notice. This also applies to products already on order provided that such alterations can be made without subsequential changes being necessary in specifications already agreed. All trademarks in this material are property of the respective companies. Danfoss and the Danfoss logotype are trademarks of Danfoss A/S. All rights reserved.